

Geberit AquaClean 8000, complete solution

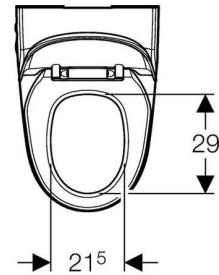
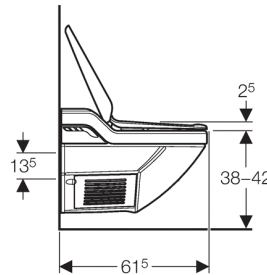
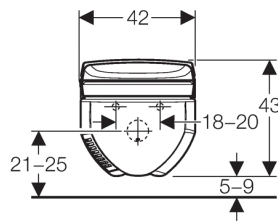

Application purpose

- For convenient toilet use
- For gentle cleaning of the anal area with water

Characteristics

- Surface-coated ceramic appliance
- Infrared user detection
- WC seat and lid with lowering function
- Spray arm with extendable nozzle for anal area
- Integrated hot water tank
- Adjustable storage water heater operating mode (ON/OFF/economy mode)
- Oscillating spray (automatic forward and reverse motion of the spray arm)
- Spray intensity adjustable in 7 levels
- Automatic pre- and post-rinsing of the spray nozzle with fresh water
- Shower spray gradually cools down continuously during shower procedure
- Most recently used settings are stored automatically
- Water supply connection on the left side

Technical data

Load WC seat / WC lid max.	150 kg
Flow rate anal shower	2.1 - 5.5 l/min
Spray time factory setting	20 s
Number of shower pressure settings	7
Storage water heater capacity	2.0 l
Length of mains connection cable	70 cm
Mains frequency	50 - 60 Hz
Power consumption	1000 W
Power consumption economy mode / with heating element switched on	1 / 9 W
Protection class	I
Protection degree	IPx4
Nominal voltage	230 V AC
Net weight	27.5 kg
Flow pressure range	1 - 10 bar
Storage temperature	-10 - +60 °C
Water temperature factory setting	37 °C

Scope of delivery

- Water supply connection set for UP300 / UP320 concealed cistern
- Acoustical insulation set
- Fastening material
- Spray shield

Article

Article no.	Colour
146.182.11.2	white alpine

- Using the supplied standard connecting material, all concealed cisterns (except for UP200) can be connected with the prepared conduit pipe.
- The UP200 concealed cistern additionally requires the reinforced braided hose with T-piece (art. no. 240.839.00.1) to be ordered.