

Geberit Duofix element for shower, 50 cm, with wall drain, dia. 50

NEW

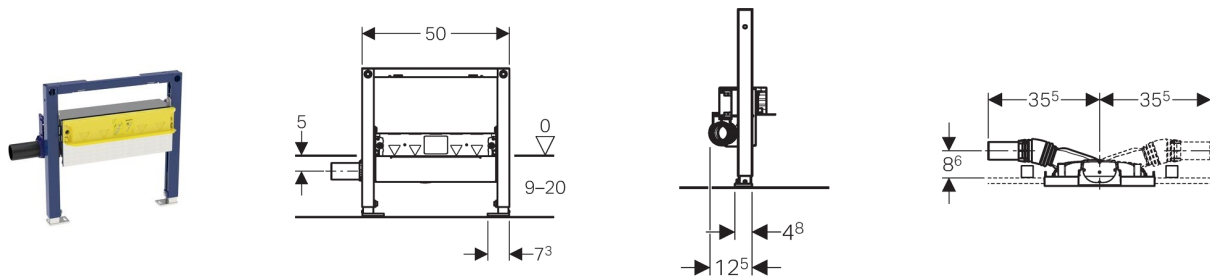

Application purpose

- For drywall construction
- For use with composite seals
- For floor constructions 9 - 20 cm

Characteristics

- Quality-monitored in accordance with EN 1253-3
- Sealing level adjustable for tension-free sealing connection
- Pre-mounted sealing fleece, 10 cm circumferential, for connecting sealing systems
- Foot plates rotating, depth suitable for installation in U-profiles UW 50 and Geberit Duofix system rails
- Inlet height of trap adjustable
- Minimum screed height at inlet 90 mm
- Panelling thickness 10 - 40 mm
- Tile structure wall and floor 4 - 26 mm
- Branch discharge left or right

Technical data

Drainage capacity	0.8 l/s
Depth of water seal	50 mm

Scope of delivery

- Straight connector, made of HDPE, dia. 50 mm
- Protection box cover with integrated outlet sheet
- Fastening material

Article

Article no.	Description
111.591.00.1	Geberit Duofix element for shower, 50 cm, with wall drain, dia. 50